

**MAYBERRY HILL PHASE 3B
 DRAFT PLAN OF SUBDIVISION
 22T-201501**

DATE: MARCH 2, 2020 DRAWN BY: A.R.N.
 PROJECT No.: 1401 SCALE: 1:1,500

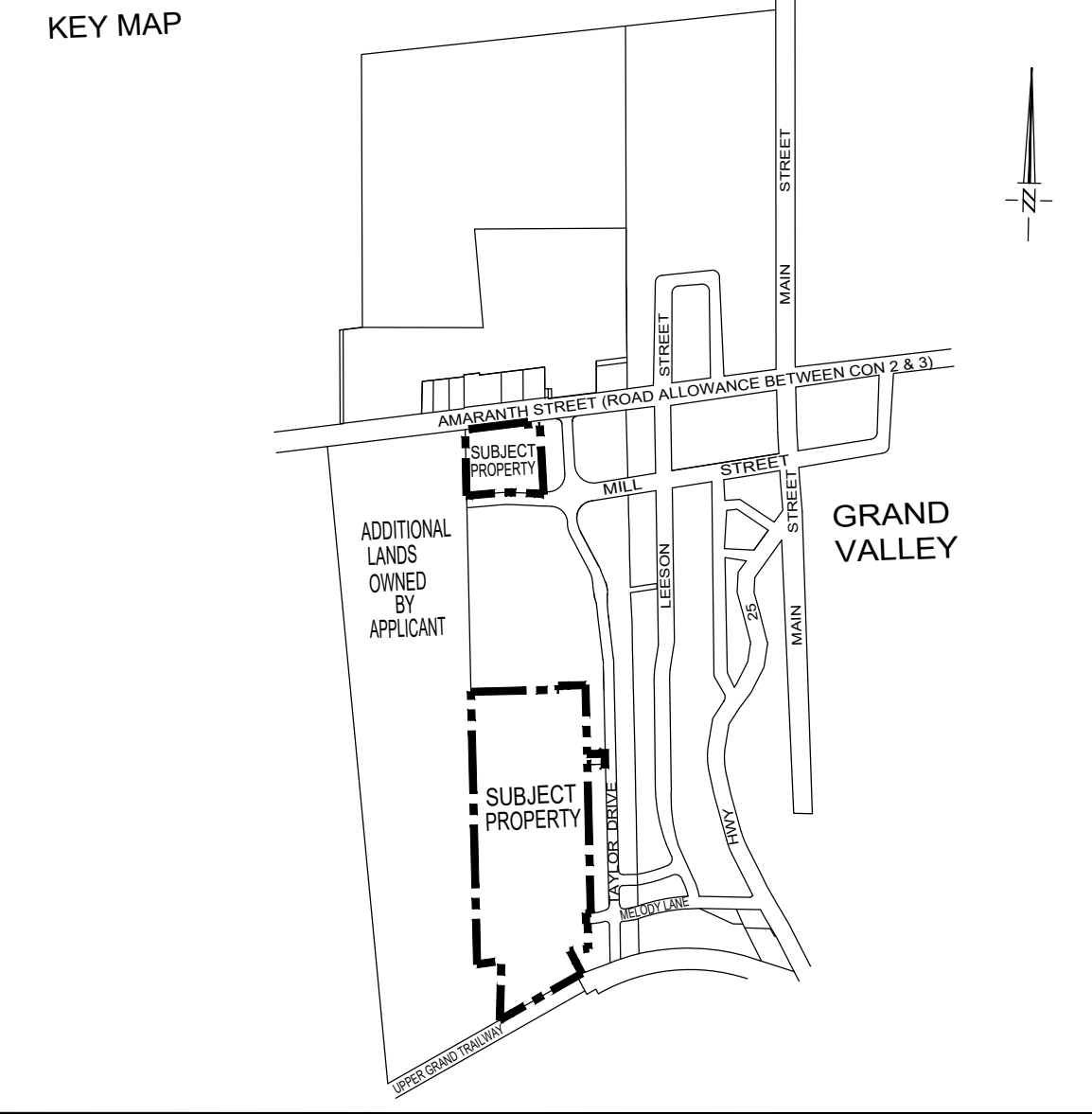

LEGAL DESCRIPTION
 Part of Lot 29 and 30, Concession 2
 (Geographic Township of East Luthar)
 Part of Block 110, All of Blocks 107, 108, 109, 112
 Registered Plan 7M-53
 Town of Grand Valley
 County of Dufferin

LAND USE SCHEDULE

DESCRIPTION	LOTS/BLOCKS	UNITS	AREA (hectares)
SINGLE DETACHED LOTS			6.562
11.6m	1-11, 34, 35-47, 52-60, 65-81, 84-97, 100-116, 139, 144, 145	85	
12.8m	12-14, 17-32, 48-51, 61-64, 73, 82, 83, 98, 99, 117-138, 140-143, 146-153	65	
14.32m	15, 16, 33	3	
TOWNHOUSE	154	57	1.912
STORMWATER MANAGEMENT	155, 156	-	1.831
OPEN SPACE	157	-	0.812
ROAD WIDENING	158	-	0.045
ROADS	-	-	3.933
TOTAL	158	210	15.095

NOTES
 11.6m = 15m CORNER
 12.8m = 16.1m CORNER
 14.32m = 17.62m CORNER
 FRONT YARD 7m
 REAR YARD 6m

ADDITIONAL INFORMATION
 (UNDER SECTION 51(1) OF THE PLANNING ACT)
 INFORMATION REQUIRED BY CLAUSES a,b,c,d,e,f,g,j AND I ARE AS SHOWN ON DRAFT PLAN.
 i) municipal water supply
 j) silt loam and loam till soils
 k) municipal sanitary and storm sewers

OWNER'S CERTIFICATE
 I AUTHORIZE ASTRID J. CLOS PLANNING CONSULTANTS LIMITED TO PREPARE AND SUBMIT THIS DRAFT PLAN OF SUBDIVISION.
 Tom Krizan
 TOM KRIZAN
 THOMASFIELD HOMES LIMITED
 JULY 21, 2018
 DATE

SURVEYOR'S CERTIFICATE
 I CERTIFY THAT THE BOUNDARIES OF THE LAND TO BE SUBDIVIDED AND THEIR RELATIONSHIP TO THE ADJACENT LANDS ARE CORRECTLY SHOWN.
 JOHN POTT, O.L.S.
 VAN HARTEN SURVEYING INC.
 MARCH 2, 2020
 DATE

