

Document Path: P:\32000\32657-000 - Grand Valley Official Plan Update\06-Production\02-Plan\32657-OP-Schedule D-MinAggResource.mxd

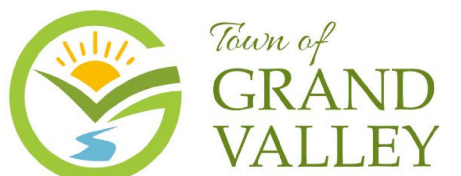
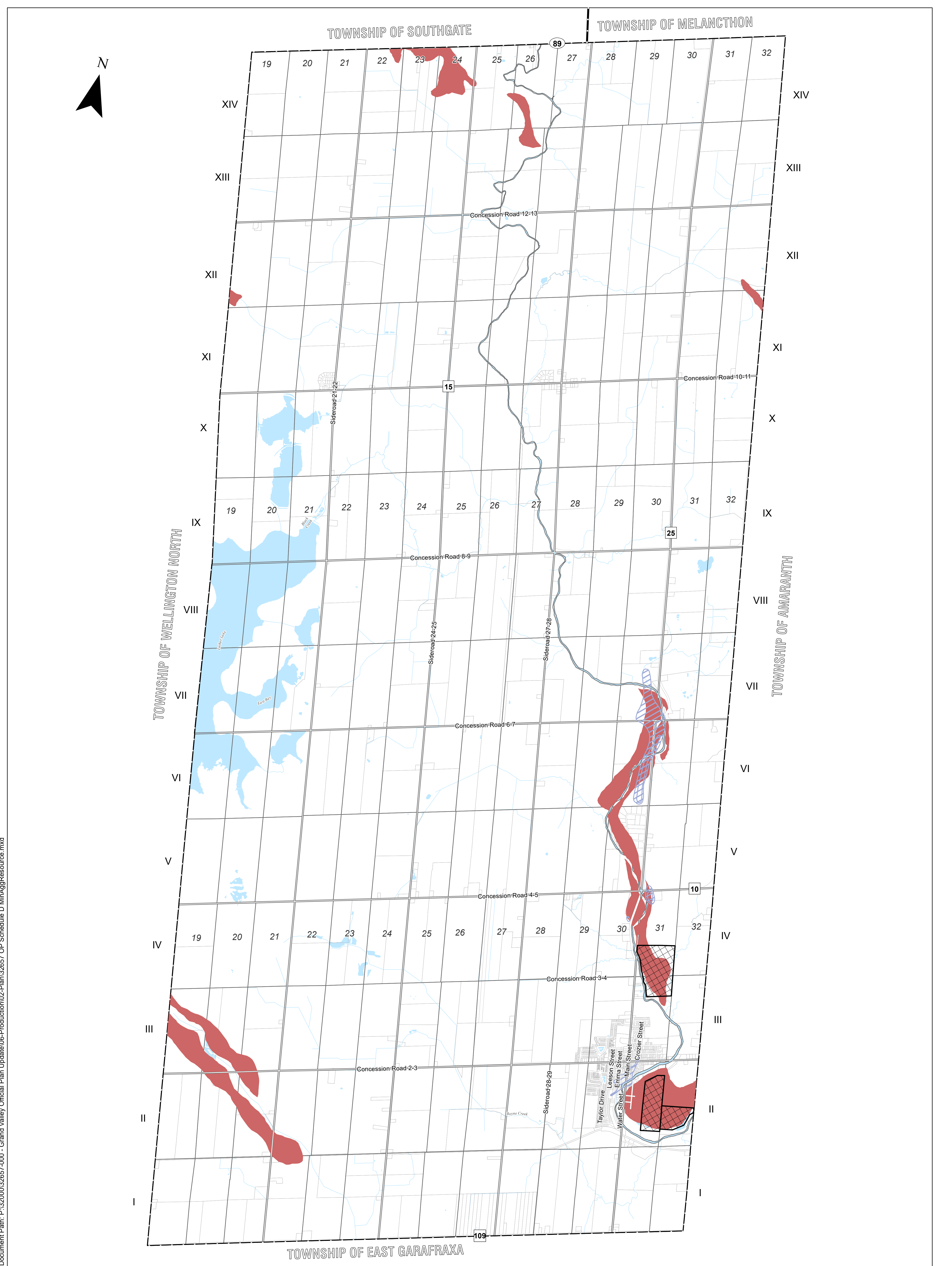

Official Plan

Town of Grand Valley

Schedule D Mineral Aggregate Resources

Legend

- Provincial Highway
- County Road
- Municipal Boundary
- Geographic Lot Fabric
- Watercourse
- Waterbody

Mineral Aggregate Resources

- Mineral Aggregate Resource Operation
- Sand and Gravel Resource Area
- Bedrock Resource Area

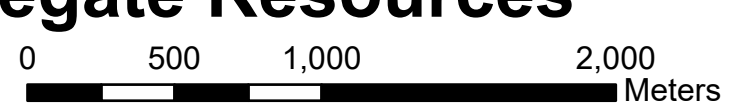

Adopted:
Print Date: 18-Sep-2024
JLR No.: 32657-000

Data Source: Source Data has been provided by the Ministry of Natural Resources, Grand River Conservation Authority, Dufferin County and Town of Grand Valley

