

Document Path: P:\32000\32657-000 - Grand Valley Official Plan Update\06-Production\02-Plan\32657-OP-Schedule C1 Natural HMI Hazards.mxd

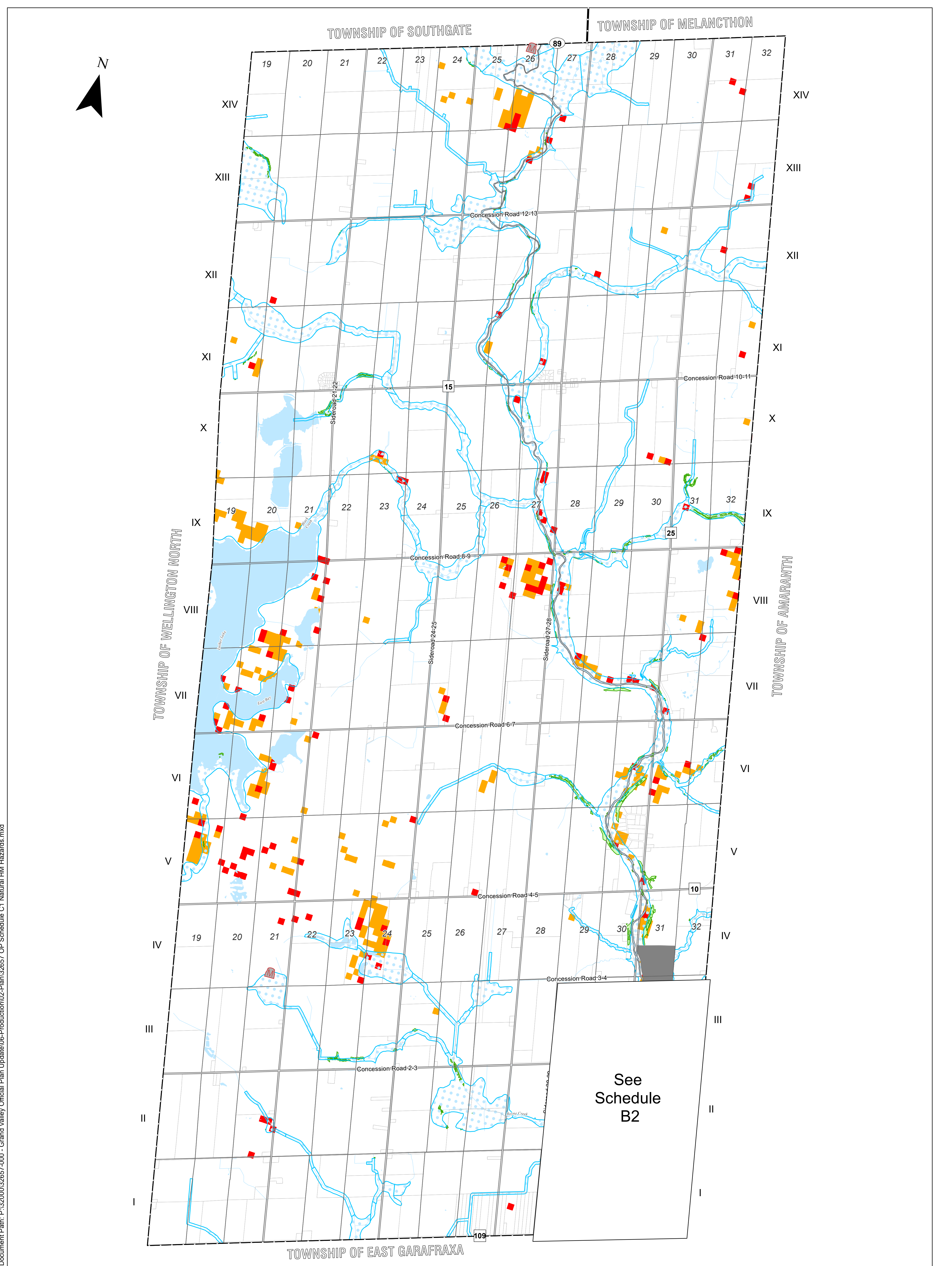

Official Plan
Town of Grand Valley
Schedule C1
Natural and Human Made Hazards



- Legend**
- Provincial Highway
 - County Road
 - Municipal Boundary
 - Geographic Lot Fabric
 - Watercourse
 - Waterbody
- Natural and Human Made Hazards**
- Waste Disposal Site Inactive
 - Floodplain (GRCA)
 - River Slope Hazard (GRCA)
 - Aggregate Site Authorized Active
 - Wildland Fire Risk Extreme
 - Wildland Fire Risk High

Data Source: Source Data has been provided by the Ministry of Natural Resources, Grand River Conservation Authority, Dufferin County and Town of Grand Valley



Adopted:
 Print Date: 18-Sep-2024
 JLR No.: 32657-000