

NOTES:
 1. NO TREE SURVEY WAS PROVIDED. EXISTING TREE LOCATIONS HAVE BEEN APPROXIMATED ON THE PLAN.
 2. SHARED/NEIGHBOURING TREES WILL BE IMPACTED BY CONSTRUCTION. REMOVAL OF SHARED/NEIGHBOURING TREES SHALL REQUIRE NEIGHBOUR'S/OWNER'S APPROVAL PRIOR TO REMOVAL.

REFER TO SHEET L0.1 FOR TREE INVENTORY AND TREE PROTECTION FENCE DETAILS

WORKING WITH TREE PROTECTION ZONES / TREE DRIFLINES:
 1. NO WORK IS PERMITTED WITHIN THE EXTENTS OF THE TREE PROTECTION FENCING.
 2. MINIMIZE WORKS TO THE GREATEST EXTENT POSSIBLE WITHIN THE TREE PROTECTION ZONES.
 3. ALL WORKS THAT ARE REQUIRED WITHIN THE TREE PROTECTION ZONE DURING CONSTRUCTION SHALL BE COMPLETED WITH HAND MACHINERY ONLY. ANY MATERIAL REMOVAL SHALL BE DONE USING AN AIR SPADE.
 4. ROOTS OVER 4CM DIAMETER THAT ARE ENCOUNTERED SHALL BE PRUNED BY A QUALIFIED ARBORIST.
 5. IT IS RECOMMENDED A QUALIFIED ARBORIST BE PRESENT ONSITE TO MONITOR DISRUPTION DURING WORKS WITHIN THE TREE PROTECTION ZONES.

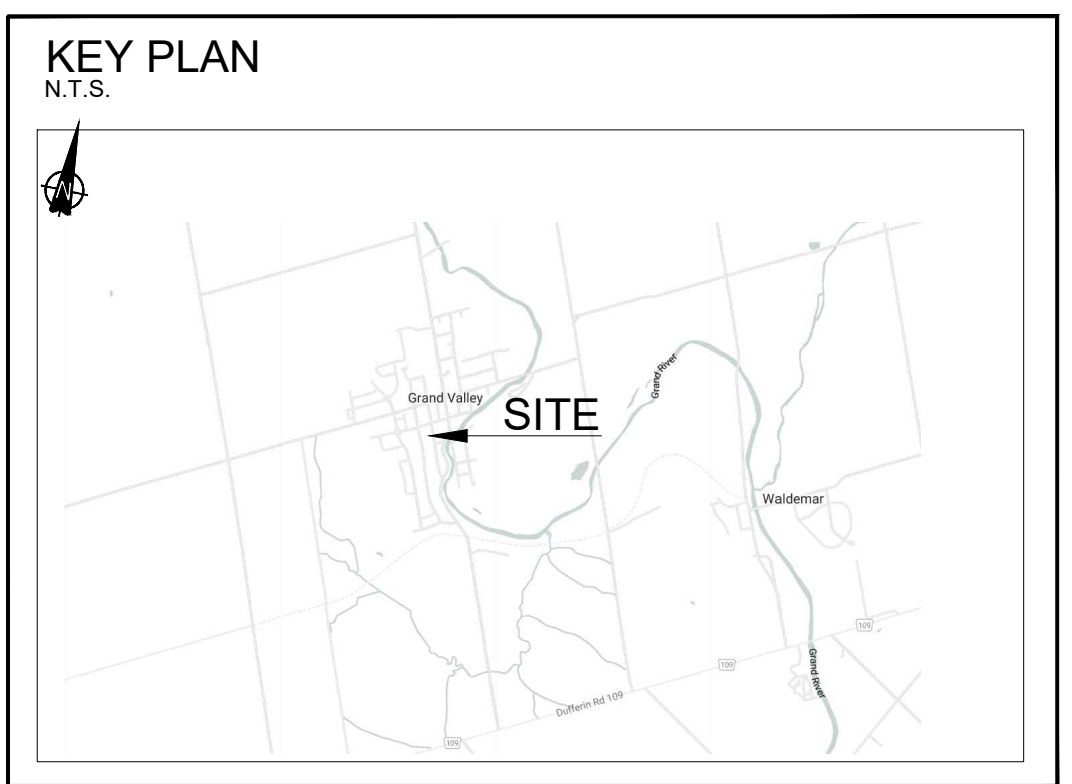

Legend

- EXISTING TREE TO REMAIN
- EXISTING TREE TO BE REMOVED
- TREE PROTECTION FENCING
- TREE IDENTIFICATION NUMBER

GENERAL NOTES:

1. DRAWINGS NOT TO BE USED FOR CONSTRUCTION UNLESS AUTHORIZED BY THE LANDSCAPE ARCHITECT
2. CONTRACTOR SHALL REPORT ANY DISCREPANCIES BETWEEN THE DRAWINGS AND SITE CONDITIONS PRIOR TO COMMENCEMENT OF THE WORK
3. ALL UTILITY LOCATES ARE THE RESPONSIBILITY OF THE CONTRACTOR. HAND DIG WITHIN THE LIMITS RECOMMENDED BY THE SERVICE UTILITY. UTILITY CONFLICTS WITH PROPOSED TREE LOCATIONS MUST BE REPORTED IMMEDIATELY TO THE LANDSCAPE ARCHITECT
4. BASE DRAWING PROVIDED BY THE CLIENT.
5. VEGETATION INVENTORY BY GSP GROUP.
6. FOR GRADING INFORMATION REFER TO DRAWING BY MOOREFIELD EXCAVATING. FOR SERVICING INFORMATION REFER TO DRAWINGS BY MOOREFIELD EXCAVATING.
7. SURVEY DRAWING BY VAN HARTEN SURVEYING INC.
8. LANDSCAPE DRAWINGS SHOW ENGINEERING INFORMATION FOR DESIGN PURPOSES ONLY. DO NOT CONSTRUCT ENGINEERING WORKS FROM THESE DRAWINGS.

VEGETATION MANAGEMENT PLAN
 SHELDON CREEK DEVELOPMENTS
 40-60 EMMA STREET S.
 GRAND VALLEY, ON

ISSUED FOR SITE PLAN APPROVAL, NOT FOR CONSTRUCTION.

DATE	ISSUE	BY
06.06.2023	ISSUE FOR APPROVAL	LB
11.09.2023	ISSUE FOR CLIENT REVIEW	MS
06.10.2024	ISSUE FOR CLIENT REVIEW	MS
12.18.2024	ISSUE FOR CLIENT REVIEW	MS
12.20.2024	ISSUE FOR SPA SUBMISSION	LB

DATE	REVISIONS	BY

251-72 Victoria Street South
 Mississauga, Ontario L5S 1K9
 T 905.988.8883
 F 905.988.9562

182 Locke Street South, Suite 200
 Hamilton, Ontario L8P 1A8
 T 905.572.7477

www.gspgroup.ca

Date: SEPT 11 2023
 Scale: 1:125
 Drawn By: LB, OS, MS
 Project No.: 23107

0:07

NOTE:
TREES SHOULD NOT BE PLANTED WITHIN 3.0M OF THE
RETAINING WALL OR WITH IN 1H:1V ENVELOPE
MEASURED FROM THE BACK OF THE BOTTOM OF THE
RETAINING WALL STRUCTURE, WHICHEVER IS GREATER

PLANT SCHEDULE SITE

CODE	QTY	BOTANICAL NAME	COMMON NAME	SIZE	CONTAINER	SPACING	REMARKS
CONIFEROUS TREES							
PG	4	<i>Picea glauca</i>	White Spruce	200cm Ht.	W.B.		
PPU	5	<i>Picea pungens</i>	Colorado Spruce	200cm Ht.	W.B.		
TO	7	<i>Thuja occidentalis</i>	Eastern White Cedar	150cm Ht.	W.B.		
DECIDUOUS TREES							
AFC	2	<i>Acer freemanii</i> 'Celzam' TM	Celebration Maple	60mm Cal.	W.B.		
AFJ	2	<i>Acer freemanii</i> 'Jeffersred' TM	Autumn Blaze Maple	60mm Cal.	W.B.		
AR	2	<i>Acer rubrum</i>	Red Maple	60mm Cal.	W.B.		
CO	2	<i>Celtis occidentalis</i>	Common Hackberry	60mm Cal.	W.B.		
QMA	3	<i>Quercus macrocarpa</i>	Burr Oak	60mm Cal.	W.B.		
SRI	4	<i>Syringa reticulata</i> 'Ivory Silk'	Ivory Silk Japanese Tree Lilac	60mm Cal.	W.B.		
TR	2	<i>Tilia americana</i> 'Redmond'	Redmond American Linden	60mm Cal.	W.B.		
CONIFEROUS SHRUBS							
TmD	10	<i>Taxus x media</i> 'Densiformis'	Dense Yew	50cm	3 gal.	1.5 m	
DECIDUOUS SHRUBS							
Rr	6	<i>Rosa rugosa</i>	Rugosa Rose	40cm	3 gal.	1.25 m	
SpG	23	<i>Spiraea japonica</i> 'Goldflame'	Goldflame Spirea	60cm	3 gal.	0.9 m	
ORNAMENTAL GRASSES							
caK2	8	<i>Calamagrostis acutiflora</i> 'Karl Foerster'	Feather Reed Grass	---	1 gal.	0.7 m	
VINES							
Pq	2	<i>Parthenocissus quinquefolia</i>	Virginia Creeper	---	1 gal. staked	0.5 m	
PERENNIALS							
hPD	11	<i>Hemerocallis</i> x 'Purple D'oro'	Purple D'oro Daylily	---	1 gal.	450 mm	
hs	55	<i>Hemerocallis</i> x 'Stella D'Oro'	Stella D'Oro Daylily	---	1 gal.	530 mm	

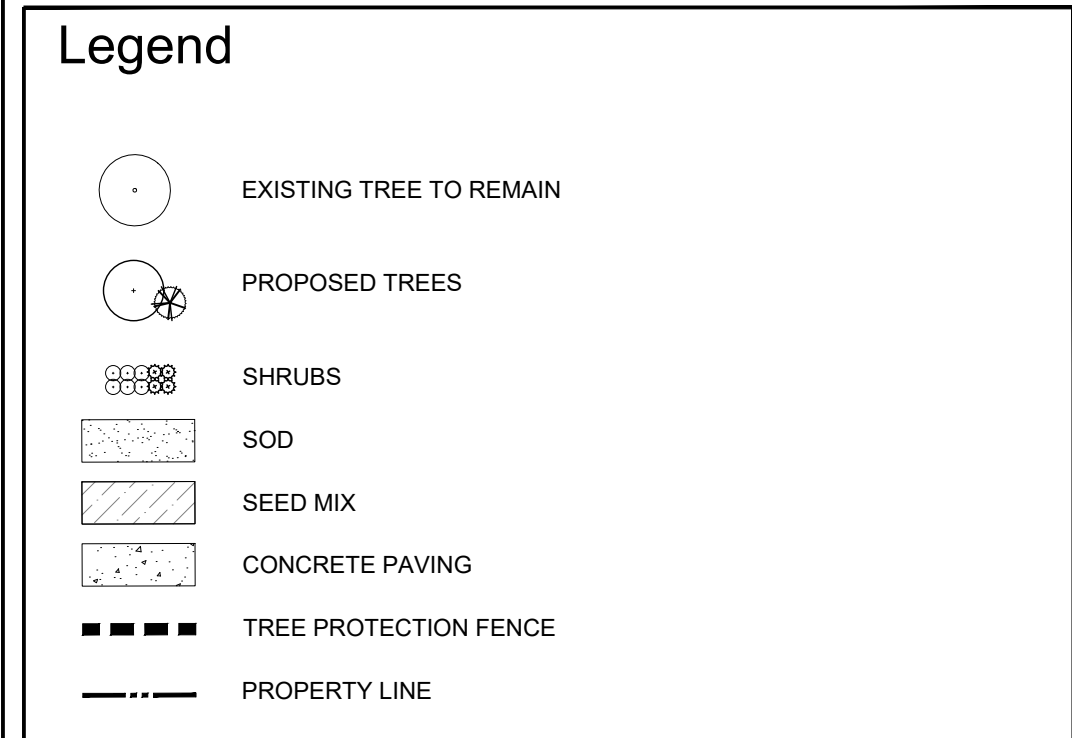
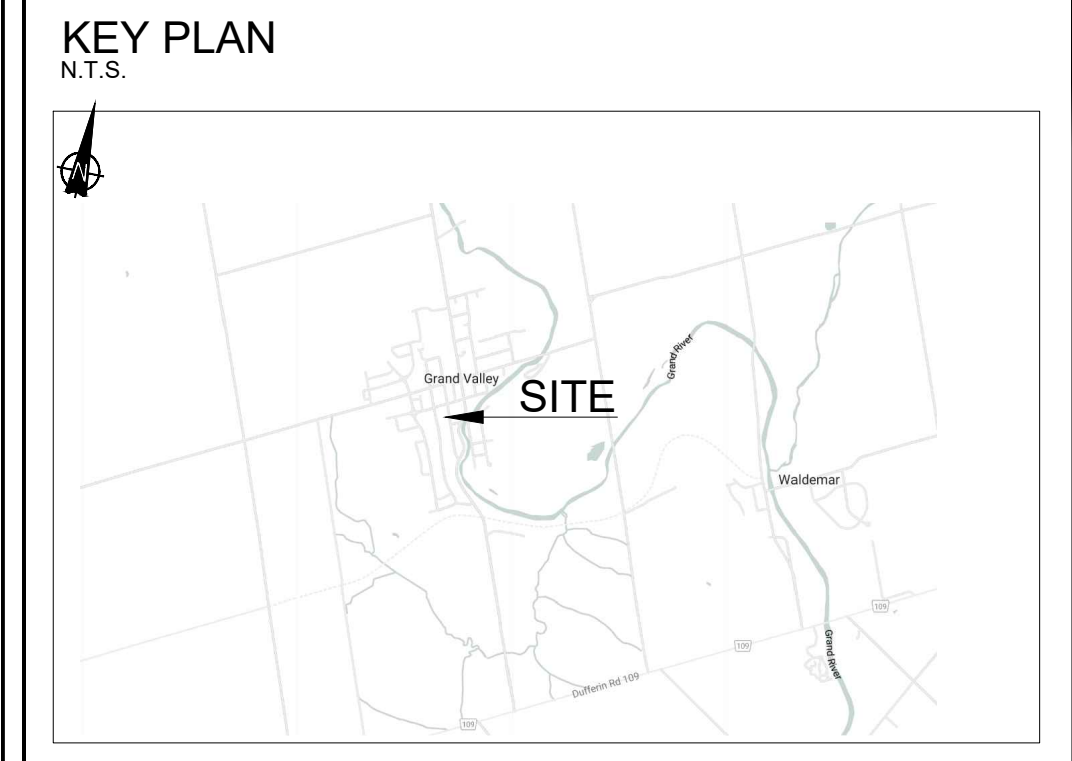

- GENERAL NOTES:**
1. DRAWINGS NOT TO BE USED FOR CONSTRUCTION UNLESS AUTHORIZED BY THE LANDSCAPE ARCHITECT
 2. CONTRACTOR SHALL REPORT ANY DISCREPANCIES BETWEEN THE DRAWINGS AND SITE CONDITIONS PRIOR TO COMMENCEMENT OF THE WORK
 3. ALL UTILITY LOCATES ARE THE RESPONSIBILITY OF THE CONTRACTOR. HAND DIG WITHIN THE LIMITS RECOMMENDED BY THE SERVICE UTILITY. UTILITY CONFLICTS WITH PROPOSED TREE LOCATIONS MUST BE REPORTED IMMEDIATELY TO THE LANDSCAPE ARCHITECT
 4. BASE DRAWING PROVIDED BY THE CLIENT.
 5. VEGETATION INVENTORY BY GSP GROUP.
 6. FOR GRADING INFORMATION REFER TO DRAWING BY MOOREFIELD EXCAVATING. FOR SERVICING INFORMATION REFER TO DRAWINGS BY MOOREFIELD EXCAVATING.
 7. SURVEY DRAWING BY VAN HARTEN SURVEYING INC.
 8. LANDSCAPE DRAWINGS SHOW ENGINEERING INFORMATION FOR DESIGN PURPOSES ONLY. DO NOT CONSTRUCT ENGINEERING WORKS FROM THESE DRAWINGS.

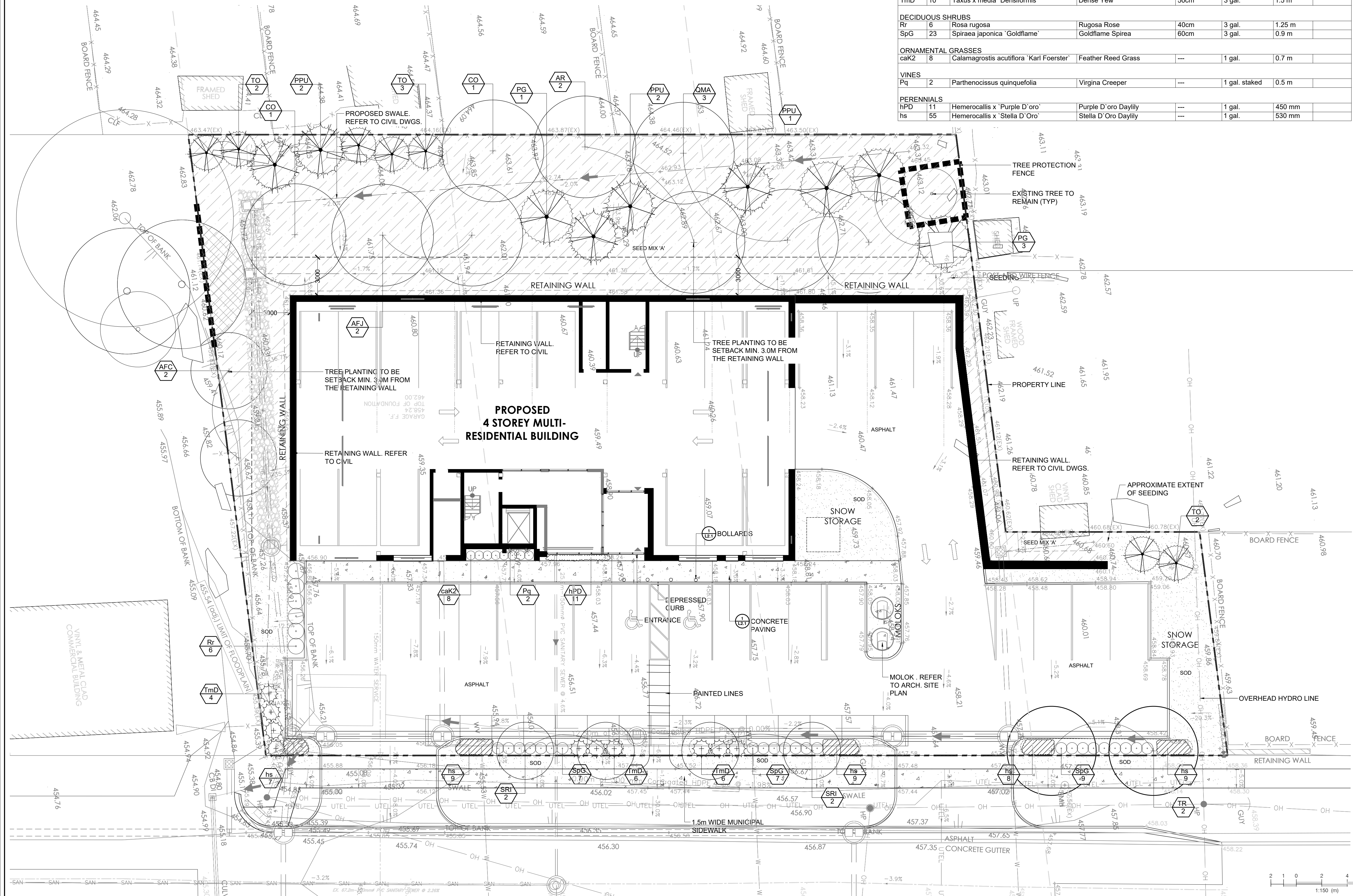

LANDSCAPE PLAN
SHELDON CREEK DEVELOPMENTS
40-60 EMMA STREET S.
GRAND VALLEY, ON

ISSUED FOR SITE PLAN APPROVAL, NOT FOR CONSTRUCTION.

DATE	ISSUE	BY
05.06.2023	ISSUE FOR APPROVAL	LB
11.09.2023	ISSUE FOR CLIENT REVIEW	MS
06.10.2024	ISSUE FOR CLIENT REVIEW	MS
12.18.2024	ISSUE FOR CLIENT REVIEW	MS
12.20.2024	ISSUE FOR SPA SUBMISSION	LB

DATE	REVISIONS	BY

20172 Victoria Street South
Newmarket, Ontario M9C 4P9
T 905 886 8843
F 905 886 8800
www.gspgroup.ca

182 Locke Street South, Suite 200
Newmarket, Ontario M9C 4A8
T 905 527 7477
Project No.: 23107

Date: SEPT 11 2023
Scale: 1:150

Drawn By: LB, OS, MS
Project No.: 23107

0.17

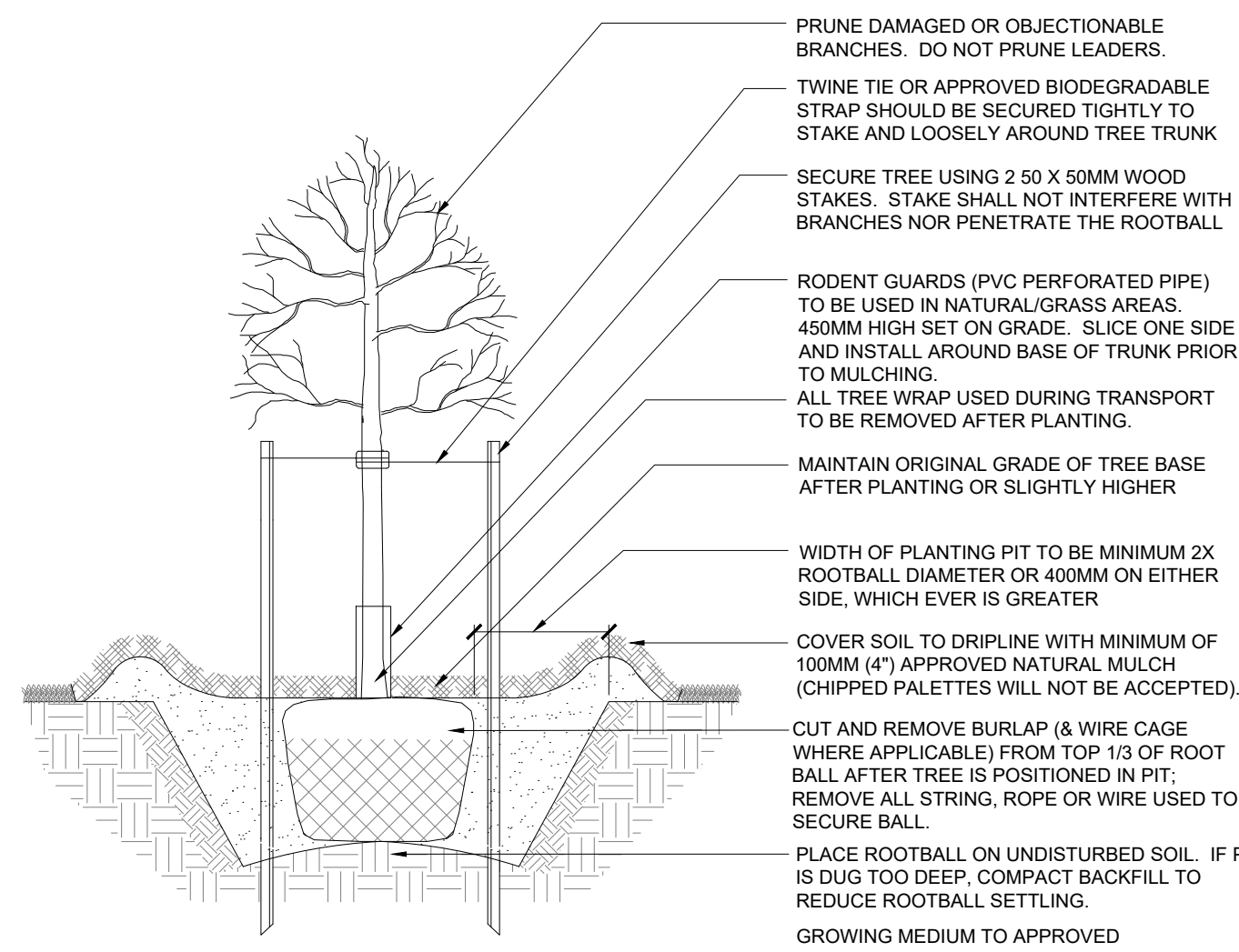

- NOTES**
1. GROWING MEDIUM MIX: 4 PARTS TOPSOIL, 1 PART COMPOST, 1 PART SHREDDED PEAT & APPLICATION OF HIGH PHOSPHOROUS FERTILIZER (0-20-0)
 2. PLANT MATERIAL SHALL BE THOROUGHLY WATERED AT TIME OF PLANTING.
 3. PLANT MATERIAL SHALL BE SET PLUMB IN THE MIDDLE OF THE PIT.
 4. TREE SHALL BEAR SAME RELATION OR SLIGHTLY HIGHER TO FINISHED GRADE AS ORIGINALLY GROWN.
 5. PLANT STOCK MOVED WHILE IN LEAF SHALL BE COVERED WHILE IN TRANSIT. ROOTS SHOULD BE KEPT MOIST UNTIL PLANTED. TREES IN LEAF TO BE TREATED WITH ANTI-DESICCANT.
 6. DIMENSIONS ARE IN MILLIMETERS UNLESS OTHERWISE NOTED.
 7. STAKING IS TO OCCUR ONLY AT THE DIRECTION OF THE LANDSCAPE ARCHITECT.
 8. 100MM HIGH SAUCER EXCEPT WHEN PLANTING IN BED.

1 DECIDUOUS TREE PLANTING B.B/W.B - UP TO 80mm CALIPER
N.T.S.

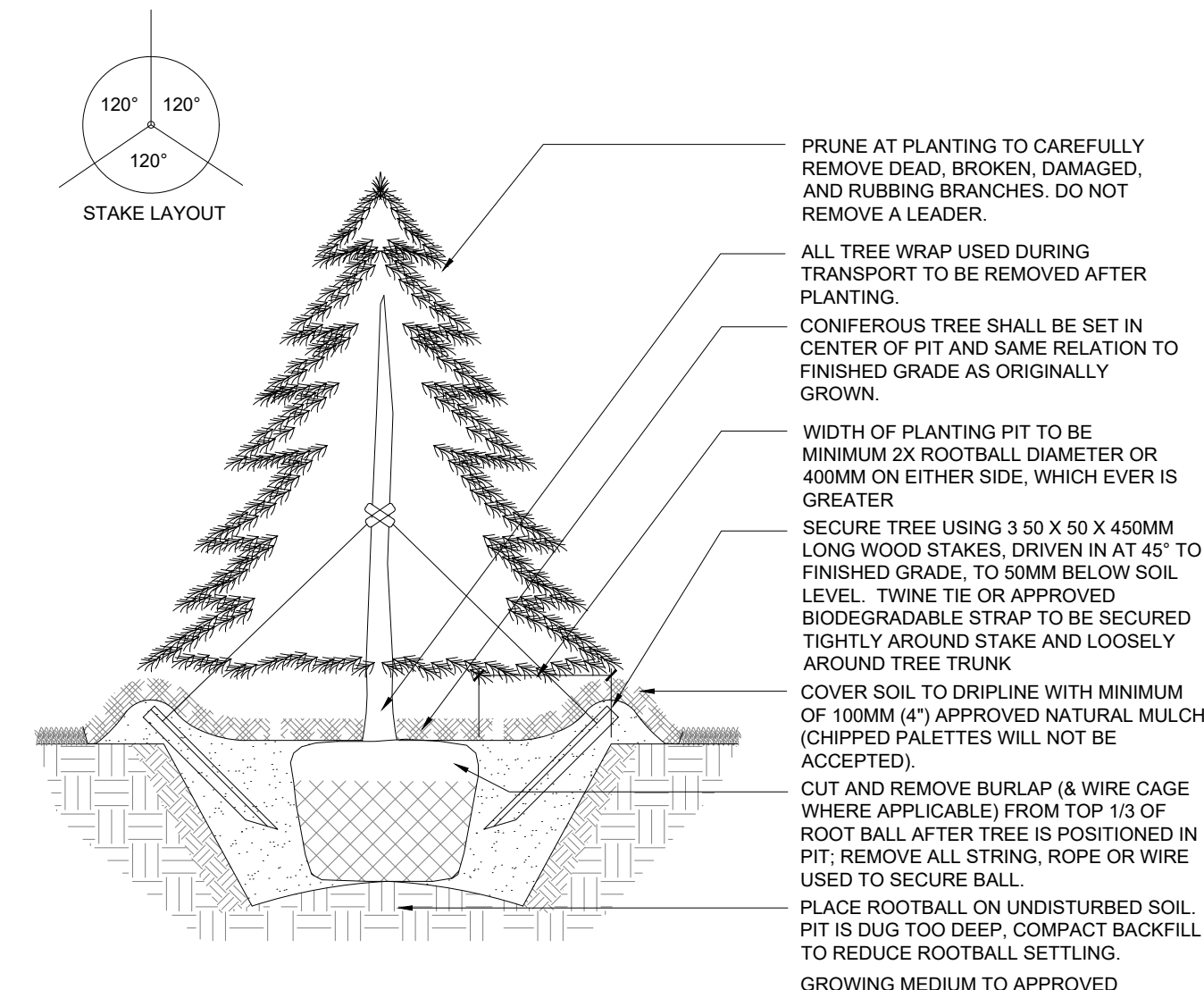

- NOTES**
1. GROWING MEDIUM MIX: 4 PARTS TOPSOIL, 1 PART COMPOST, 1 PART SHREDDED PEAT & APPLICATION OF HIGH PHOSPHOROUS FERTILIZER (0-20-0)
 2. PLANT MATERIAL SHALL BE THOROUGHLY WATERED AT TIME OF PLANTING.
 3. PLANT MATERIAL SHALL BE SET PLUMB IN THE MIDDLE OF THE PIT.
 4. TREE SHALL BEAR SAME RELATION OR SLIGHTLY HIGHER TO FINISHED GRADE AS ORIGINALLY GROWN.
 5. PLANT STOCK SHALL BE COVERED WHILE IN TRANSIT. ROOTS SHOULD BE KEPT MOIST UNTIL PLANTED. TREES TO BE TREATED WITH ANTI-DESICCANT.
 6. DIMENSIONS ARE IN MILLIMETERS UNLESS OTHERWISE NOTED.
 7. STAKING IS TO OCCUR ONLY AT THE DIRECTION OF THE LANDSCAPE ARCHITECT.
 8. 100MM HIGH SAUCER EXCEPT WHEN PLANTING IN BED.

2 CONIFEROUS TREE PLANTING - UP TO 2.5M HEIGHT (B.B/W.B)
N.T.S.



3 TYPICAL PLANTING BED EDGE
SCALE 1:10

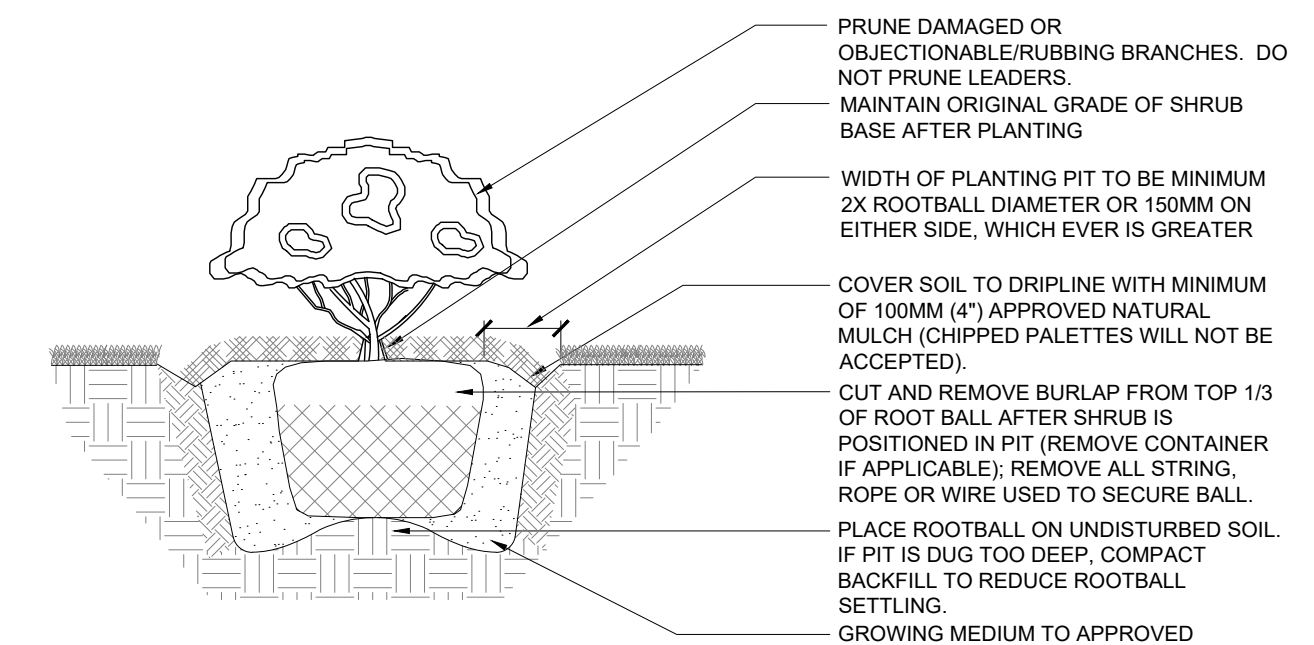

- NOTES**
1. GROWING MEDIUM MIXTURE: 4 PARTS TOPSOIL, 1 PART COMPOST, 1 PART SHREDDED PEAT & APPLICATION OF HIGH PHOSPHOROUS FERTILIZER (0-20-0)
 2. PLANTING BED SHALL BE THOROUGHLY WATERED IMMEDIATELY AFTER PLANTING & PRIOR TO MULCHING.
 3. FOR POTTED SHRUBS, SATURATE CONTAINER ROOTS/STOCK PRIOR TO REMOVAL OF CONTAINER BEFORE PLANTING.
 4. SHRUBS ARE TO BE SPACED AS DIRECTED.
 5. ALL DIMENSIONS ARE IN MILLIMETERS.

4 B&B/CONTAINER STOCK SHRUB PLANTING
N.T.S.

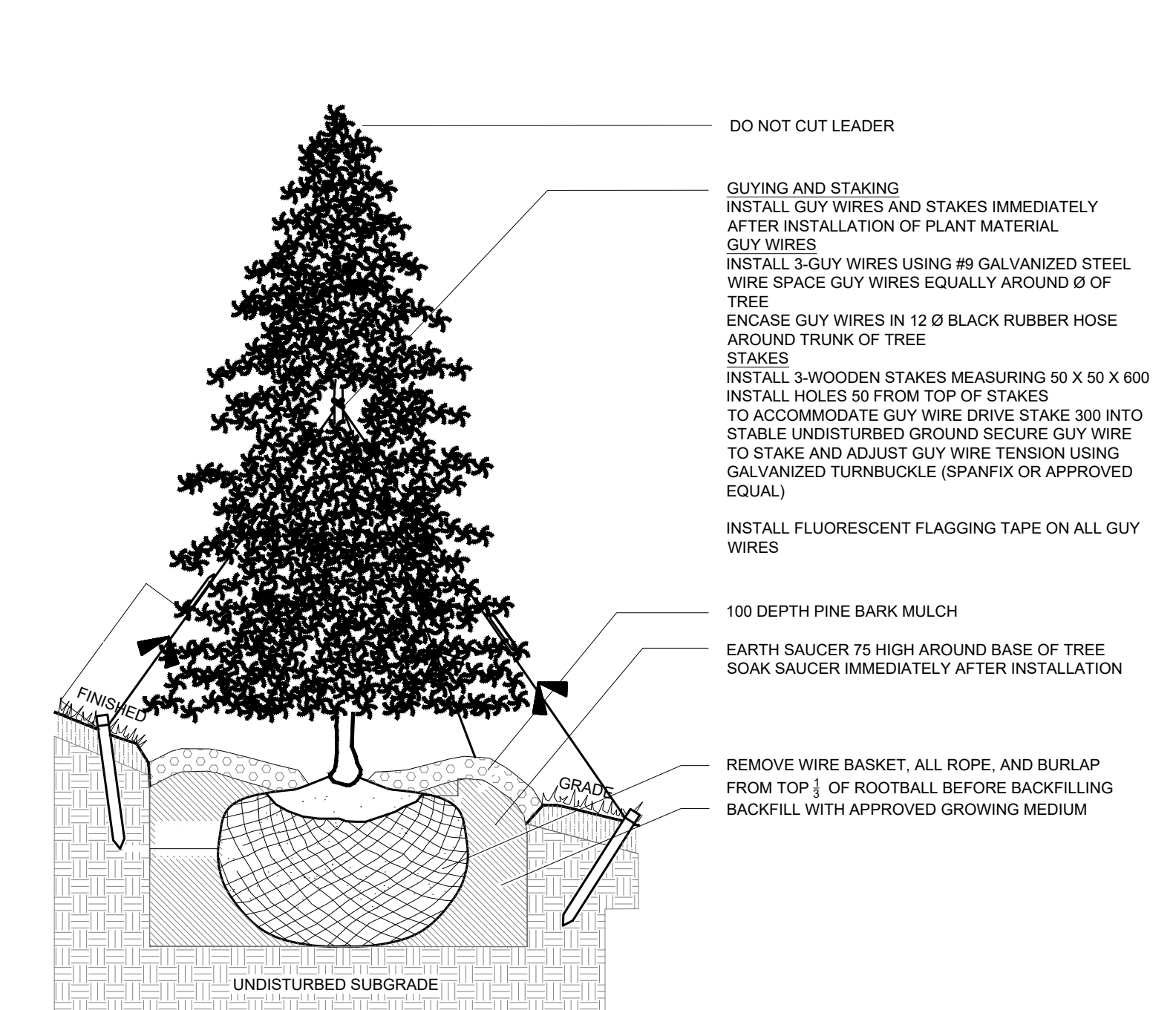

- NOTES**
1. ALL DIMENSIONS IN MILLIMETERS UNLESS OTHERWISE NOTED.
 2. BACKFILL WITH APPROVED GROWING MEDIUM.
 3. PLANTING PIT DEPTH WILL BE THE SAME DEPTH AS THE ROOT BALL AND 900 OR 1.5 TIMES THE WIDTH - WHICHEVER IS GREATER.
 4. WIRE TWISTED AROUND TREE GUARD WILL BE TWISTED BACK TO TREE SIDE OF GUARD.
 5. TREE BASE AT TRUNK WILL BEAR SAME RELATION TO FINISHED GRADE AS IT BORE TO PREVIOUS EXISTING GRADE.
 6. SOAK COMPLETELY WITH WATER AND MULCH IMMEDIATELY.
 7. PLANT TREE 75 ABOVE EXISTING ADJACENT GRADE TO ACCOMMODATE SETTLEMENT.

5 Coniferous Tree Planting On A Slope
N.T.S.

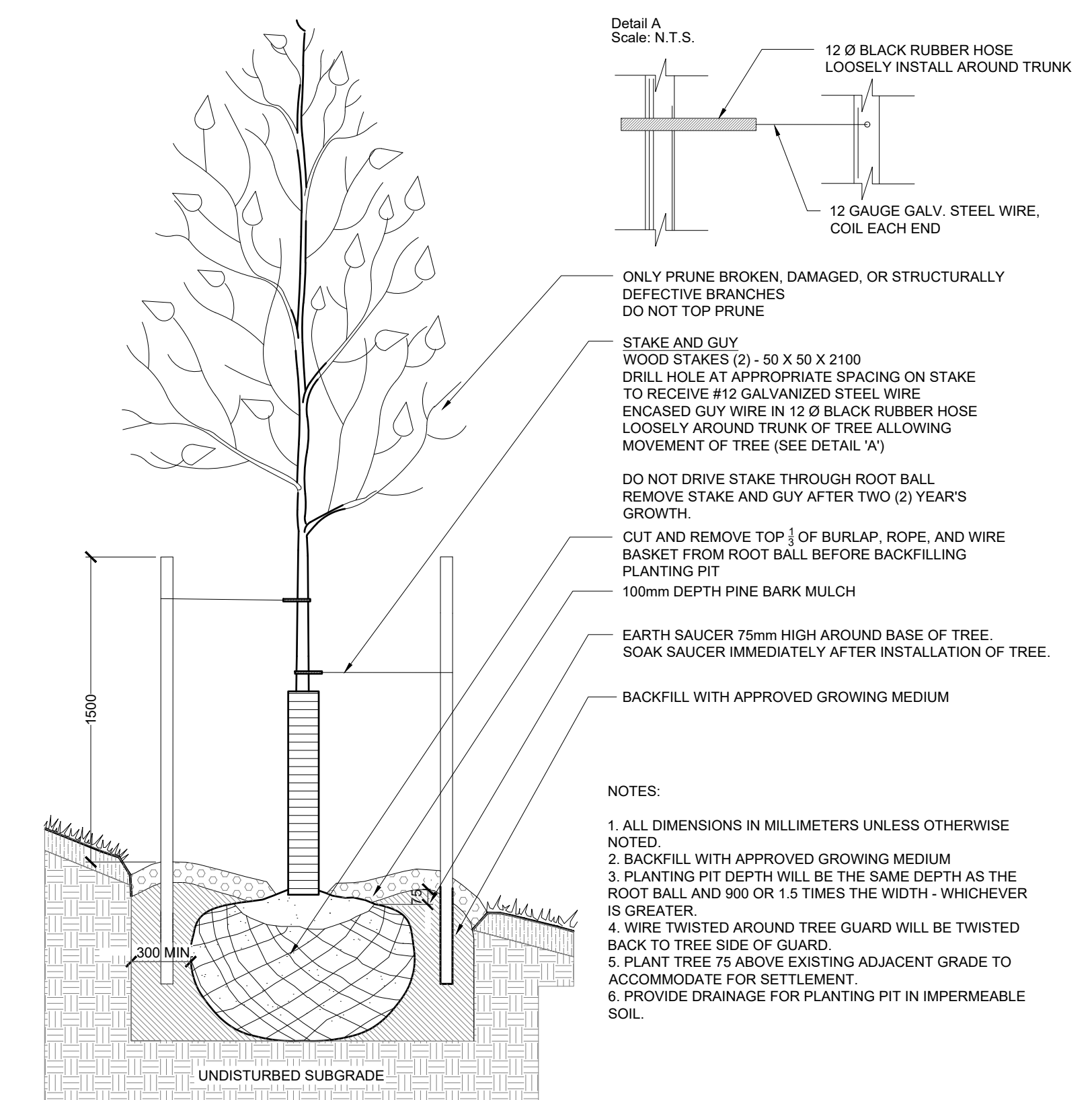

- NOTES**
1. ALL DIMENSIONS IN MILLIMETERS UNLESS OTHERWISE NOTED.
 2. BACKFILL WITH APPROVED GROWING MEDIUM.
 3. PLANTING PIT DEPTH WILL BE THE SAME DEPTH AS THE ROOT BALL AND 900 OR 1.5 TIMES THE WIDTH - WHICHEVER IS GREATER.
 4. WIRE TWISTED AROUND TREE GUARD WILL BE TWISTED BACK TO TREE SIDE OF GUARD.
 5. PLANT TREE 75 ABOVE EXISTING ADJACENT GRADE TO ACCOMMODATE FOR SETTLEMENT.
 6. PROVIDE DRAINAGE FOR PLANTING PIT IN IMPERMEABLE SOIL.

6 Deciduous Tree Planting On A Slope
N.T.S.

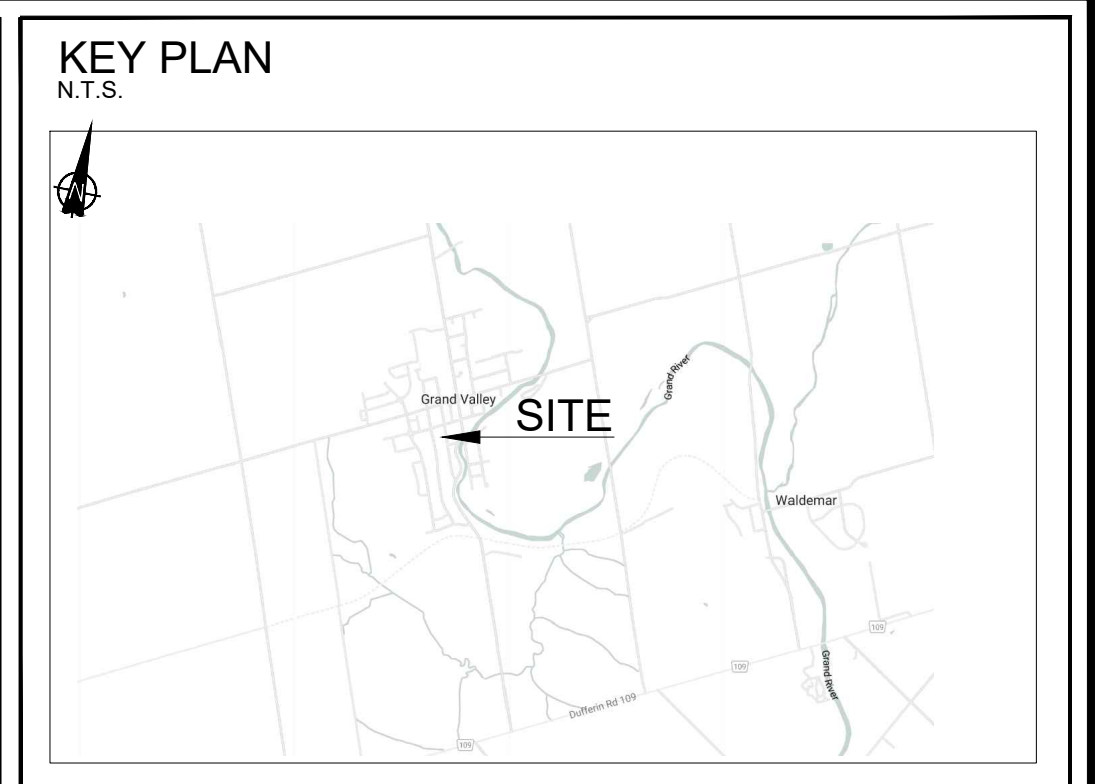

Legend

GENERAL NOTES:

1. DRAWINGS NOT TO BE USED FOR CONSTRUCTION UNLESS AUTHORIZED BY THE LANDSCAPE ARCHITECT
2. CONTRACTOR SHALL REPORT ANY DISCREPANCIES BETWEEN THE DRAWINGS AND SITE CONDITIONS PRIOR TO COMMENCEMENT OF THE WORK.
3. ALL UTILITY LOCATES ARE THE RESPONSIBILITY OF THE CONTRACTOR. HAND DIG WITHIN THE LIMITS RECOMMENDED BY THE SERVICE UTILITY. UTILITY CONFLICTS WITH PROPOSED TREE LOCATIONS MUST BE REPORTED IMMEDIATELY TO THE LANDSCAPE ARCHITECT
4. BASE DRAWING PROVIDED BY THE CLIENT.
5. VEGETATION INVENTORY BY GSP GROUP.
6. FOR GRADING INFORMATION REFER TO DRAWING BY MOOREFIELD EXCAVATING. FOR SERVICING INFORMATION REFER TO DRAWINGS BY MOOREFIELD EXCAVATING.
7. SURVEY DRAWING BY VAN HARTEN SURVEYING INC.
8. LANDSCAPE DRAWINGS SHOW ENGINEERING INFORMATION FOR DESIGN PURPOSES ONLY. DO NOT CONSTRUCT ENGINEERING WORKS FROM THESE DRAWINGS.

DETAILS

SHELDON CREEK DEVELOPMENTS
40-60 EMMA STREET S.
GRAND VALLEY, ON

ISSUED FOR SITE PLAN APPROVAL, NOT FOR CONSTRUCTION.

DATE	ISSUE	BY
05.06.2023	ISSUE FOR APPROVAL	LB
11.09.2023	ISSUE FOR CLIENT REVIEW	MS
06.10.2024	ISSUE FOR CLIENT REVIEW	MS
12.18.2024	ISSUE FOR CLIENT REVIEW	MS
12.20.2024	ISSUE FOR SPA SUBMISSION	LB

DATE	REVISIONS	BY

201-71 Victoria Street South
Hamilton, Ontario N8Y 1Y9
T 905 885-8863
F 905 885-8864

901 Locke Street South, Suite 206
Hamilton, Ontario L8P 4A9
T 905 572-1477
F 905 572-1478

www.gspgroup.ca

Date: SEPT 11 2023
Scale: N.T.S.

Drawn By: LB, OS, MS
Project No.: 23107

L2.0

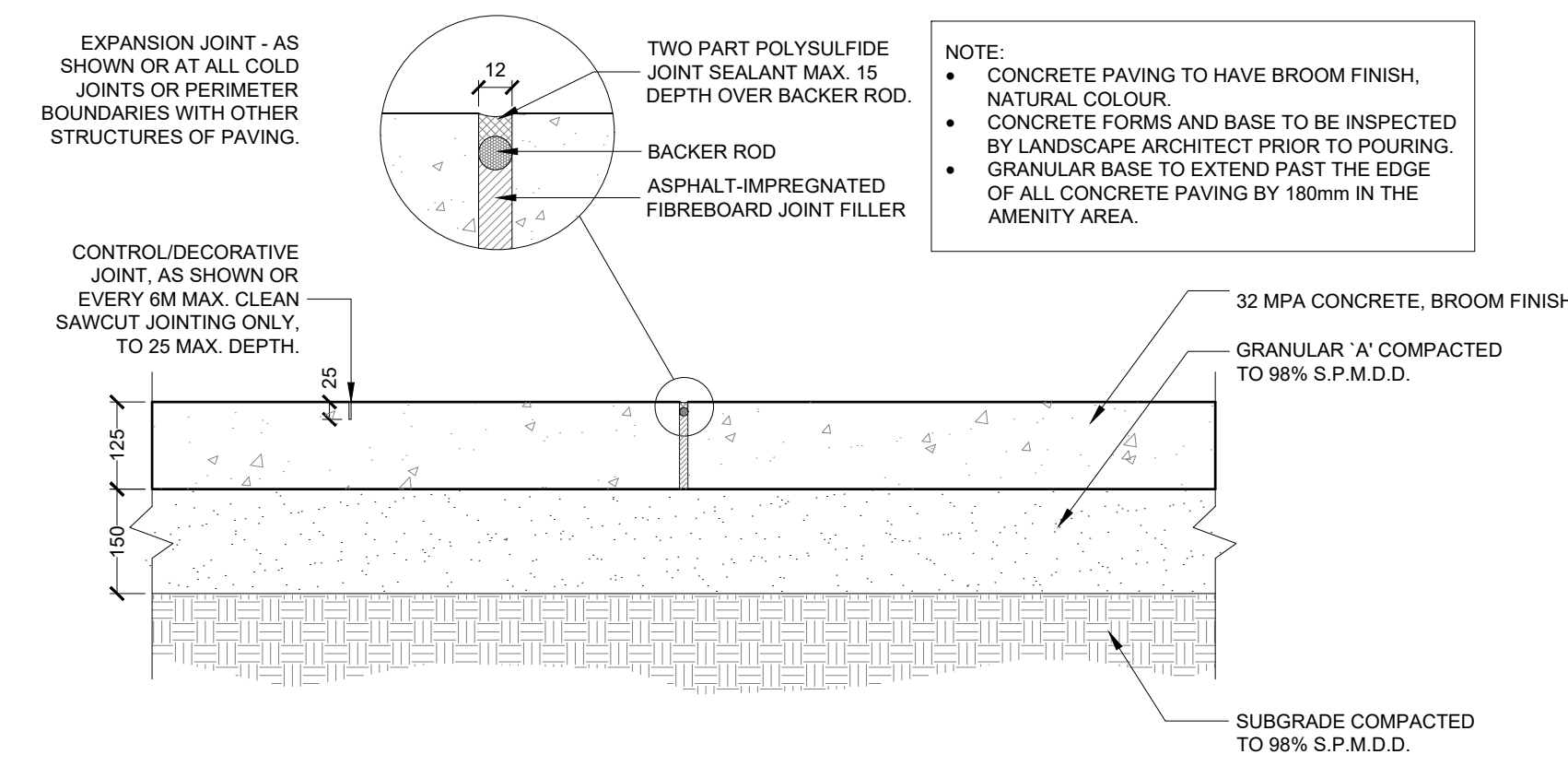

1 CONCRETE PAVING W/ BROOM FINISH - ON GRADE
N.T.S.

PLANTING NOTES:

1. ALL PLANT MATERIAL SHALL BE NO. 1 NURSERY GROWN, MEETING SPECIFICATIONS FOR SIZE, HEIGHT, SPREAD, GRADING, QUALITY, METHOD OF CULTIVATION, AND BALLING AND BURLAP SPECIFICATIONS AS SET OUT IN THE 8TH EDITION 2006 GUIDE SPECIFICATION FOR NURSERY STOCK PREPARED BY THE CNLA.
2. NO SUBSTITUTIONS IN SPECIES, CULTIVAR, QUANTITY, SIZE OR CONDITION WILL BE PERMITTED WITHOUT THE WRITTEN APPROVAL OF THE CONSULTANT. ANY UNAPPROVED SUBSTITUTED MATERIAL WILL BE REQUIRED TO BE REMOVED FROM THE SITE AT THE EXPENSE OF THE CONTRACTOR.
3. ANY INCONSISTENCIES FOUND IN THE QUANTITIES AS SHOWN ON THE PLAN AND THE PLANT LIST SHALL BE IMMEDIATELY REPORTED TO THE CONSULTANT.
4. LAYOUT SHALL BE THE RESPONSIBILITY OF THE CONTRACTOR. LAYOUT, PLANT STAKE-OUT AND DELIVERED PLANT MATERIAL SHALL BE APPROVED BY THE CONSULTANT PRIOR TO INSTALLATION.
5. NATIVE OR IMPORTED TOPSOIL SHALL BE TESTED AS SPECIFIED AND APPROVED BY THE CONSULTANT PRIOR TO ADDING ANY AMENDMENTS AND PLACEMENT. PLANTING MIX, WHERE INDICATED, SHALL FOLLOW THE MIX SPECIFICATIONS.
6. PROVIDE TOPSOIL DEPTH AS FOLLOWS:
BOULEVARDS (NON-TREED): 300MM MINIMUM CONTINUOUS DEPTH
SHRUB PLANTING BEDS: 500MM MINIMUM CONTINUOUS DEPTH
TREE PLANTING PITS/BEDS: 600MM MINIMUM CONTINUOUS DEPTH
SODDED/SEEDED AREAS (NON-BOULEVARD): 300MM MINIMUM CONTINUOUS DEPTH
ALL BEDS SHALL BE MULCHED WITH APPROVED MULCH TO A MINIMUM DEPTH OF 100MM, UNLESS OTHERWISE NOTED. DEPTHS SHALL BE THOSE ACHIEVED UNDER LIGHT COMPACTION. AREAS TO BE SODDED OR SEEDED SHALL BE PROVIDED WITH 300 MM OF APPROVED TOPSOIL, COMPACTED TO 85% SPD.
7. NO BARE-ROOT PLANTING SHALL BE PERMITTED BETWEEN MAY 15 AND OCTOBER 15.
8. PLANT MATERIAL SHALL BE THOROUGHLY WATERED AT THE TIME OF PLANTING.
9. THOSE AREAS NOT SPECIFICALLY IDENTIFIED FOR PLANTING, OR OTHERWISE NOTED, SHALL BE SODDED. SODDING SHALL BE MAINTAINED AND WARRANTED UNTIL FIRST CUT. SEEDING SHALL BE MAINTAINED AND WARRANTED UNTIL OCTOBER 1 FOR SPRING SEEDING AND JUNE 1 FOR FALL SEEDING.
10. ALL TREES AND SHRUBS SHALL BE UNDER WARRANTY FOR A PERIOD OF 24 MONTHS COMMENCING ON THE DATE OF ACCEPTANCE.
11. THE CONTRACTOR SHALL PROVIDE MAINTENANCE IMMEDIATELY AFTER THE PLANTS ARE INSTALLED AND CONTINUE THROUGHOUT THE ENTIRE WARRANTY PERIOD. MAINTENANCE REQUIREMENTS SHALL INCLUDE ALL PROCEDURES CONSISTENT WITH PROPER HORTICULTURAL PRACTICES TO ENSURE NORMAL, VIGOROUS, AND HEALTHY GROWTH OF ALL MATERIAL PLANTED. ALL STAKES, WIRE, HOSE, AND OTHER ACCESSORIES MUST BE REMOVED PRIOR TO FINAL WARRANTY INSPECTION.
12. ALL PLANT MATERIAL USED AS REPLACEMENTS FOR UNACCEPTABLE MATERIAL SHALL BE OF THE SAME QUALITY AND REQUIREMENTS PRESCRIBED FOR THE ORIGINAL MATERIAL. REPLACEMENTS SHALL BE MADE ONCE UNDER THE WARRANTY.

GROWING MEDIUM REQUIREMENTS:

1. CONTRACTOR TO PROVIDE SOIL TESTING RESULTS OF GROWING MEDIUM TO LANDSCAPE CONSULTANT FOR APPROVAL PRIOR TO INSTALLATION.
2. CONTRACTOR SHALL PREPARE PLANTING BEDS AND TREE PITS WITH APPROVED GROWING MEDIUM PRIOR TO INSTALLATION OF PLANT MATERIAL.
3. CONTRACTOR SHALL PAY ALL COSTS TO CORRECT GROWING MEDIUM AND REPLACEMENT OF PLANT MATERIAL IF SPECIFIED TESTS, AMENDMENTS, AND WRITTEN APPROVAL OF THE LANDSCAPE CONSULTANT ARE NOT OBTAINED.

NOTE:
ALL DESIGNATED SEED AREAS TO BE FINE GRADED AS PER ENGINEERING DRAWINGS

GRASS SEED MIXES
SUPPLIED BY ONTARIO SEED COMPANY, OR APPROVED ALTERNATE

SEEDING NOTES

1. SEEDING PERFORMED PRIOR TO VICTORIA DAY OR BETWEEN MID-AUGUST AND SEPTEMBER 15 TO BE BY SLIT SEEDING WITH 2 PASSES USING A MECHANICAL SLIT-SEEDER AT SUPPLIER'S RECOMMENDED RATE. FOLLOW WITH A BROADCAST APPLICATION OF STARTER FERTILIZER, 15-30-15 OR SIMILAR 1:2:1 RATIO, WITH 2 PASSES AT 12 KG/HA (0.25 LBS/ACRE) IN EACH DIRECTION.
2. SEEDING PERFORMED BETWEEN VICTORIA DAY AND MID AUGUST SHALL BE BROADCAST WITH 2 PASSES USING A CYCLONE OR DROP-TYPE SEEDER AT SUPPLIER'S RECOMMENDED RATE. MULCH TO BE LIGHT APPLICATION OF CHOPPED STRAW. OVER SEEDING WILL BE REQUIRED AND SHALL BE PERFORMED IN SEPTEMBER WITH "TOP GUN" PERENNIAL RYEGRASS BY OSC AT THE SUPPLIER'S RECOMMENDED RATE. OVERSEEDING SHALL BE BY 2 PASSES USING A MECHANICAL SLIT-SEEDER.
3. APPLY HYDRAULIC MIXTURE EVENLY AND UNIFORMLY AND AT SUCH A RATE TO MEET THE COVERAGE SPECIFIED IN OPSS 572.
4. STRAW SHOULD JUST COVER THE SOIL SURFACE, BUT NOT BURY IT. SOME SOIL SHOULD BE VISIBLE THROUGH THE STRAW - 10%.
5. ALL SEEDING TO BE APPLIED THROUGH HYDRAULIC METHOD EXCEPT AREAS WHERE CONDITIONS WILL ONLY PERMIT MECHANICAL SEEDING.
6. ALL SEEDING APPLICATIONS TO MEET OPSS 804 STANDARDS AND SPECIFICATIONS.
7. APPLY SEED AND HYDRAULIC MIXTURE EVENLY AND UNIFORMLY AND AT SUCH A RATE TO MEET THE COVERAGE SPECIFIED.

SEED MIX A - STORMWATER POND MIX

LATIN NAMES	COMMON NAMES	% IN MIX
<i>Elymus canadensis</i>	Canada Wild Rye	15
<i>Rudbeckia hirta</i>	Black Eyed Susan	3
<i>Poa palustris</i>	Fowl Bluegrass	25
<i>Carex vulpinoidea</i>	Fox Sedge	15
<i>Sorghastrum nutans</i>	Indiangrass	15
<i>Aster novae-angliae</i>	New England Aster	2
<i>Elymus virginicus</i>	Virginia Rye	25

NURSE CROPP:
100% Lolium (Ryegrass)
Seed at rate of 22 kg./ha

SEED MIX B - LAWN AND MOWN AREAS

30% Lolium perenne cultivar	Perennial Ryegrass
20% Festuca ovina cultivar	Sheeps Fescue
20% Festuca rubra	Chewings Fescue
15% Festuca trachyphylla cultivar	Hard Fescue
15% Poa pratensis cultivar	Kentucky Bluegrass

Seed at rate of 5 lbs./1000 square feet.

GROWING MEDIUM NOTES:

- 1.0 GROWING MEDIUM TESTING:
1.1 GROWING MEDIUMS (TOPSOIL, PLANTING MIXES) AND ORGANIC AMENDMENTS MUST BE TESTED BY AN OMAFRA ACCREDITED AGENCY AND APPROVED PRIOR TO USE. TEST TOPSOIL FOR P, K, CA AND MG, MINOR ELEMENT VALUES, SOLUBLE SALT CONTENT, ORGANIC MATTER, TEXTURE AND PH VALUE APPROPRIATE FOR THE ESTABLISHMENT AND GROWTH OF ORNAMENTAL NURSERY STOCK. SUBMIT TEST RESULTS AND ANALYSIS INCLUDING RECOMMENDATIONS FOR AMENDMENTS AND FERTILIZER TO THE CONSULTANT.
- 2.0 TOPSOIL:
2.1 TOPSOIL SHALL BE FERTILE, FRIABLE, TOPSOIL, FREE OF: FRAGMENTS LARGER THAN 75MM IN SIZE; STONES OVER 30MM IN DIAMETER; DEBRIS; PLANTS OR THEIR ROOTS; STICKS; NOXIOUS SEED PLANTS; STOLONS; SEEDS; SALTS; SOIL STERILANTS; CHEMICAL CONTAMINANTS; OTHER MATERIALS DETRIMENTAL TO PLANT GROWTH.
2.2 FERTILIZER AND AMENDMENTS: MUST BE MADE AS PER SOIL TESTING AGENCY RECOMMENDATIONS.
2.3 ALL TOPSOIL FOR THE INTENSIVE USE LAWN AREAS SHALL BE SANDY LOAM CLASS ONLY.
2.4 TOPSOIL: SHALL NOT BE MOVED, DELIVERED OR WORKED ON WHILE IN A FROZEN STATE OR CONDITION.
- 3.0 GROWING MEDIUM - PLANTING MIXES:
3.1 PLANTING MIX (WHERE SPECIFIED) SHALL BE THOROUGHLY COMBINED PRIOR TO PLACEMENT IN PLANTING BED AREAS TO THE FOLLOWING PROPORTIONS: 4 PARTS APPROVED TOPSOIL, 1 PART COMPOST, 1 PART SHREDDED PEAT MOSS AND AN APPLICATION OF HIGH PHOSPHOROUS FERTILIZER (0-20-0).
3.2 MIXES CONTAINING A SIGNIFICANT AMOUNT OF PEAT MOSS SHALL NOT BE PERMITTED TO DRY OUT. THE MOISTURE CONTENT OF THE PEAT MOSS AT THE TIME OF MIXING SHALL BE NOT LESS THAN 60% TO 75%.

3 PLANTING NOTES

4 SEEDING NOTES

5 SEEDING LEGEND

MBO-0500-00004
Legacy # MTB500-B2

500 SERIES

MATERIALS: The bollard is constructed of H.S. steel tube.

FINISH: The bollard is protected with E-Coat rust proofing and finished with the Maglin Powdercoat System.

INSTALLATION: Base Type - B2 Threaded rod is set into concrete. Bollard is screwed onto rod and tightened.

TO SPECIFY: Select MBO-0500-00004
Choose:
- Powdercoat Color

HEIGHT: 34.5" (87.6cm) **DIAMETER:** 4.5" (11.4cm) **WEIGHT:** 32.66lbs (14.8kg)

MAGLIN
Site Furniture

T 800 776 6506
F 877 260 9393
www.maglin.com
sales@maglin.com

- All drawings, specifications, design and details on this page remain the property of Maglin Site Furniture Inc. and may not be used without Maglin authorization.
- Details and specifications may vary due to continuing improvements of our products.

2 BOLLARD
N.T.S.

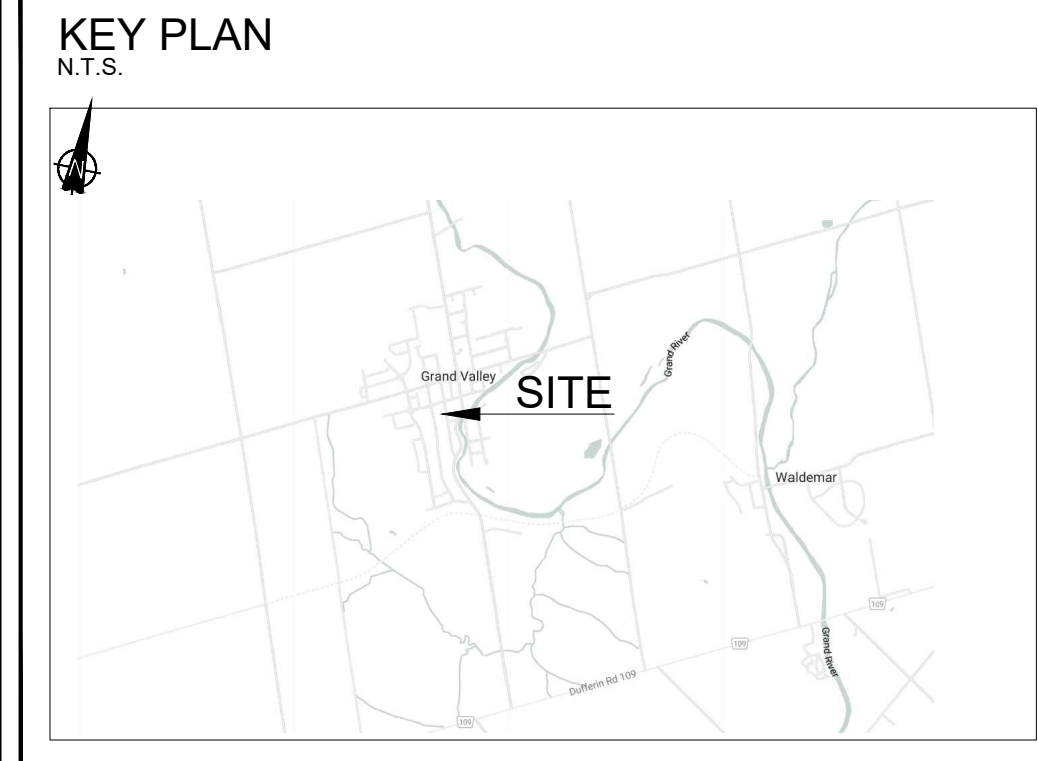

- Legend**
- GENERAL NOTES:**
1. DRAWINGS NOT TO BE USED FOR CONSTRUCTION UNLESS AUTHORIZED BY THE LANDSCAPE ARCHITECT
 2. CONTRACTOR SHALL REPORT ANY DISCREPANCIES BETWEEN THE DRAWINGS AND SITE CONDITIONS PRIOR TO COMMENCEMENT OF THE WORK
 3. ALL UTILITY LOCATES ARE THE RESPONSIBILITY OF THE CONTRACTOR. HAND DIG WITHIN THE LIMITS RECOMMENDED BY THE SERVICE UTILITY. UTILITY CONFLICTS WITH PROPOSED TREE LOCATIONS MUST BE REPORTED IMMEDIATELY TO THE LANDSCAPE ARCHITECT
 4. BASE DRAWING PROVIDED BY THE CLIENT.
 5. VEGETATION INVENTORY BY GSP GROUP.
 6. FOR GRADING INFORMATION REFER TO DRAWING BY MOOREFIELD EXCAVATING. FOR SERVICING INFORMATION REFER TO DRAWINGS BY MOOREFIELD EXCAVATING.
 7. SURVEY DRAWING BY VAN HARTEN SURVEYING INC.
 8. LANDSCAPE DRAWINGS SHOW ENGINEERING INFORMATION FOR DESIGN PURPOSES ONLY. DO NOT CONSTRUCT ENGINEERING WORKS FROM THESE DRAWINGS.

DETAILS

SHELDON CREEK DEVELOPMENTS
40-60 EMMA STREET S.
GRAND VALLEY, ON

ISSUED FOR SITE PLAN APPROVAL, NOT FOR CONSTRUCTION.

DATE	ISSUE	BY
05.06.2023	ISSUE FOR APPROVAL	LB
11.09.2023	ISSUE FOR CLIENT REVIEW	MS
06.10.2024	ISSUE FOR CLIENT REVIEW	MS
12.18.2024	ISSUE FOR CLIENT REVIEW	MS
12.20.2024	ISSUE FOR SPA SUBMISSION	LB

DATE	REVISIONS	BY

201-77 Victoria Street South
Markham, Ontario M3J 1Y9
T 905 985 8863
F 905 985 8842

901 Lake Street South, Suite 206
Markham, Ontario M3J 4B8
T 905 972 7477
F 905 972 7477

www.gspgroup.ca

Date: SEPT 11 2023 Drawn By: LB, OS, MS
Scale: N.T.S. Project No.: 23107

L2.0